

Duo-cylinder Ø12mm, stroke 3.3mm, single acting

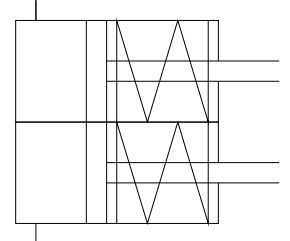
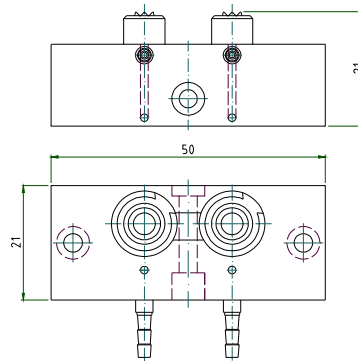
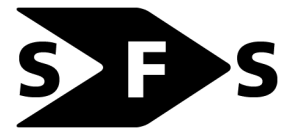

Special feature:

Two cylinders are integrated in one housing. The design of the housing is adapted specifically to the customer's mounting conditions. The cylinders can be activated individually.

Applications:

Adapter testing technology, for clamping of test samples

SPECIFICATION	
general	
design	duo-cylinder, single-acting
piston diameter	2 x 12 mm
stroke lengths	2 x 3.3 mm
actuation	pneumatic
return	spring
connection	barb fitting
ambient temperature	-20°C to +80°C
medium temperature	-20°C to +80°C
material	cylinder body anodized aluminum; rod cover brass; piston rod stainless steel; seals perbunan (NBR)
end stop damper	no
mounting method	mounting bores in the body of the cylinder
mounting position	any
magnetic scanning	no
weight	48 g
pneumatic	
control medium	filtered, lubricated or unlubricated compressed air
operating pressure range	2.5 to 8 bar